

Product Datasheet



Product Specifications:

The style and comfort of the V-Gard 200 is achieved with a fully integrated 6 point suspension system.

Cool by name, cool by nature. When we say this is one of the coolest hard hats available we mean it. The venting in the cap provides superior air flow for improved wearer comfort over longer periods.

Available in a wide range of colours.

And remember all MSA hard hats can be customized with your company logo.

- Superior airflow for the coolest protection
- Earmuff and visor attachment slots
- Textured Glaregard Finish under Peak



CoolGard White Vented Cap Fitted With 6 Point Suspension

Markets

- Construction
- Defence
- Mining
- Oil, Gas & Petrochemical

Applications

- Protection from Falling Objects
- Heat

Features and Benefits

- Lightweight ABS Cap
- Design Shaped for Maximum Ventilation
- 6 Point Harness for All Day Comfort
- AS/NZS 1801 Type I Standard Approved



Part Number

229720WH6V

Lead Time

2 days

Country of Manufacture

IT

Certification/Standard

AS/NZS 1801:1997, AS1800-2047

Major Product Group

06 - Industrial Helmets

Note: This Bulletin contains only a general description of the products shown. While uses and performance capabilities are described, under no circumstances shall the products be used by untrained or unqualified individuals and not until the product instructions including any warnings or cautions provided have been thoroughly read and understood. Only they contain the complete and detailed information concerning proper use and care of these products.

ID B20130103-AUNZ / Jan. 2013

© MSA 2010 Printed in Australia.

MSA Australia
P.O. Box 43
Wentworthville, NSW 2145
Phone (02) 9688-0333
www.msa.net.au

Customer Service
Phone 1300 728 672
Fax (02) 9896-1835
Email aus.customerservice@MSAnet.com

MSA New Zealand
The Gate
Unit E, 373 Neilson St
Onehunga, Auckland
www.msa.net.au

Customer Service
Phone 0800 441 335
Fax (09) 636-0906
Email msanz@MSAnet.com

MSA
The Safety Company



When workers are exposed to potential injury from falling debris, personal protective headwear for worker safety is essential.

But safety isn't the only issue. Comfort's important, too, for maximum compliance. That's why the highly acclaimed MSA V-Gard range of head protection equipment has been designed with worker comfort and safety as equal priorities.

STAZ-ON SUSPENSION

For quick on the head size adjustment



Head, Eye, Face and Hearing Protection

Head, Eye, Face and Hearing Protection

What do you need?

Protective industrial helmets, or hard hats, are always visible on the job site, particularly where falling hazards exist. Other personal protection can easily be attached to the hard hat to protect the face and ears.

Head protection in Australia commonly takes the form of protective caps or hats, Type I or Type II that meet the requirements of AS/NZS 1801. See the side bar for an explanation of the protection safety caps or hats provide.

MSA's vented V-Gard Advance **500** and V-CoolGard **200** have air ventilation slots to provide additional air circulation for greater comfort in hot and humid conditions. The exclusive wear and fit Staz-on suspension provides superior comfort as the wide suspension tapes allow for easy height adjustment when on the head. The professional size adjuster allows for quick and simple fitting to headsize. Our thick padded sweatband eliminates slippage and pressure points on the head.

At MSA, customization is our specialty. We can decorate your head protection with your company logo.

All of the MSA V-Gard range of head protection is designed to integrate with genuine MSA accessories such as attachment face shields with replaceable visors.

MSA hearing protection not only work exceptionally with the V-Gard range of caps but it is certified to the Australia New Zealand standards as a complete complimentary package.

Today's protective eyewear comes in stylish colours, with wraparound lenses that resist fogging and protect from the sun's harmful UV rays. Safety eyewear is lightweight and has more flexible temples, more comfortable nose bridges, and integral side shields. Lens options include clear, smoke, blue mirror and amber.

What do you want?

Workers want personal protective equipment that's so reliable, comfortable, and easy to work in that they hardly notice they are wearing it.

Employers, of course, want reliable protection that employees will wear - at value for money prices.

To keep employees safe and comply with various government standards, starting with OH+S regulations, employers must be knowledgeable about both the range of potential hazards and the types of safety equipment needed. Fortunately, along with continuous technological improvements in materials and design, every year brings new safety products that are lighter and more comfortable, reliable, and stylish!



Head Protection

Whenever workers are exposed to injury from falling debris, swinging or moving objects, molten metal splash, live overhead wires, personal protective headwear for worker safety is essential.

Scope of AS/NZS 1801:1997

Safety caps and hats are divided into a number of Types defining the testing protocols the product is subjected to and hence defines its typical applications.

Type I Cap and Hats

– Cap or hat is tested for impact protection in various conditions (-10°C, + 50°C and wet, ambient) lateral protection from side compression and electrical resistance to 650 volts. These are the most commonly used caps and hats in industrial applications.

Type II Caps and Hats

– These are subjected to the same test conditions as Type I, but have a higher elevated temperature of 120°C for impact test ensuring these are more suitable for high temperature applications such as foundries.

Type III Caps and Hats

– These are subjected to the same test conditions as Type II with the addition of specific chinstrap tests (for high strength or defined break), reflectivity of external stickers or marking and deformity testing to 200°C. These are typically used in bushfire or rescue applications.

Lens Styles

Clear	Indoor applications where no glare is experienced
Amber	Low light or indoor applications where enhanced contrast is required.
Smoke	Outdoor applications where glare is encountered
Silver Mirror/Blue Mirror	Outdoor applications where high levels of glare are encountered.
Light Gold	Indoor use and outdoor use where glare is encountered. Ideal for forklift operations
Orange; Blue	Indoor and outdoor use where no glare is encountered. Ideal for inspection applications where differences in brightness are required.

Comparison of Impact Protection

Standard	Impact Velocity			
		12 M/S	45 M/S	120 M/S
AS/NZS 1337		Low	Medium	High
EN166			Low	Medium
ANSI		Basic Z87	High Z87+	

Product Marking for AS/NZS 1337

I Medium Impact M Molten metal and hot solids resistant
 V High Impact O Outdoor Untinted

Eye and Face Protection

- The vast majority of eye injuries are caused by small particles getting into the eye.
- The more comfortable and stylish the eyewear, the more workers will wear it.

Approximately 95% of eye injuries are preventable.

- According to the optometrist Association, approximately 116,000 Australians suffer eye injuries each year.

Interesting Facts

- A survey by the bureau of statistics found that 3 out of 5 workers who suffered an eye injury wore no protection. And, of those who did, 40% wore the wrong kind.
- Most injuries are caused by metal fragments, tools, particles, chemicals, and harmful radiation (welding flash).
- Safety eyewear should be worn whenever there is a chance that machines or operations present the hazard of flying objects, chemicals, harmful radiation or a combination of these or other hazards.
- Anyone working in or passing through areas that pose eye hazards should wear appropriate protective eyewear at such times.

Safety Eyewear

AS/NZS 1337:1992 Tests

- Penetration test (impact resistance)
 - 44g dart with 40mm x 2mm needle, resulting in no penetration of lens.
- Frame Flame Propagation
 - 2mm long samples over Bunsen burner for 10 seconds. Max burning rate is 100mm/min.
- Metal components immersed in salt water for 15mins and dried for 24 hours, must retain smooth surface and be free of corrosion.
- Optical Properties
 - Refractive Power – Shall not be positive or negative 0.12m
 - Prismatic Power – Shall not exceed 0.25
- Transmittance Values
 - Untinted – 85% min
 - Outdoor Untinted – 85% min Erythema UV 1% max
 - Outdoor Tinted – 8% min 50% max Erythema UV 1% max
- Limits on red signal visibility factor (R) [for red, green, yellow colours] and violet factor (V) [colour perception]

Ultra Violet Light and Human Eye

- The ultraviolet section of the spectrum covers 100-400nm, where it merges with visible light.
- Recent research shows that the UV rays above 290nm can have significant effects on the eye lens and retina.
- Effects are cumulative; low doses over a long period can cause permanent damage.
- Rays less than 290nm from the sun are mostly absorbed by oxygen, nitrogen and ozone in the atmosphere.
- Individual sensitivity can be increased by many prescription drugs, i.e. hormones, vitamins, anti depressants etc.
- UV lenses are ideal for all outdoor workers – pilots, drivers, farmers, linesmen, builders, council workers etc.
- Persons working around highly reflective surfaces i.e. snow, water and sand are at the highest risk.
- The lens does not filter out UV rays it absorbs it and offers no reflection.
- All polycarbonate MSA lenses, both clear and tinted, absorb greater than 99% of UV rays up to 400nm. i.e. UV-C (200 - 280nm), UV-B (280 - 320nm) & UV-A (320 - 400nm).

Wavelength, Frequency and Energy

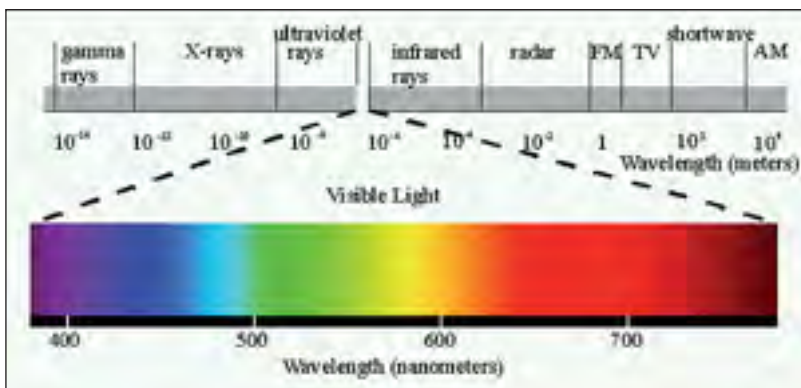

MSA Nullarbor Spectacle - Clear Lens

Transmission Values

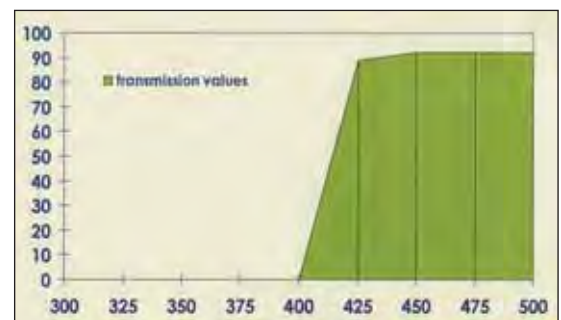

Head Protection

Visor Compatibility Chart

For use with MSA Safety Hard Hats and Caps

FACE, HEARING AND HEAD PROTECTION COMBINATIONS	left/RIGHT			SORDIN		WHERE EARMUFF IS NOT REQUIRED 30MM
	LOW WHITE HELMET MOUNTED 30MM	MEDIUM BLUE HELMET MOUNTED 30MM	HIGH YELLOW HELMET MOUNTED 30MM	EXC HELMET MOUNTED 30MM	HPE HELMET MOUNTED 30MM	
	766242	766239	766244	763932	763934	

764701	VISOR CARRIER, MSA SORDIN, V-GARD, V-GARD ADVANCE 500, V-COOLGARD 200						
VISORS	CERTIFIED TO EN 166, EN 1731						
764703	VISOR MSA SORDIN CLEAR PC 20CM (1, F, 3, 9)	•	•	•	•	•	•
765698	VISOR MSA SORDIN CLEAR PC 20CM FOR ELECTRICAL ARCS (B, 3, 8, 9)	•	•	•	•	•	•
764746	VISOR MSA SORDIN METAL MESH (S)	•	•	•	•	•	•

PC = Polycarbonate	Protection against:
1 = Optical Class 1	3 = Liquid Splash
Mechanical Strength:	8 = Short Circuit Electric Arc
B = 120 m/sec	9 = Molten Metals and Hot Solids
S = 12m/sec	
F = 45m/sec	

763142 VISOR HOLDER							
VISORS	CERTIFIED TO AS/NZS 1337 - HIGH IMPACT						
227947CL	VISOR CLEAR PC 400MM x 240MM	•	•	•	•	•	•

VISORS							
222154CL	VISOR TEMPGARD MEDIUM 400MM x 200MM CLEAR	•	•	•	•	•	•
225170CL	VISOR TEMPGARD CLEAR WITH CHINGUARD 400MM x 180MM	•	•	•	•	•	•
762115	VISOR MESH ALUMINIUM 390MM x 165MM	•	•	•	•	•	•
762116	VISOR MESH FIBREGLASS 390MM x 165MM	•	•	•	•	•	•
221411CL	VISOR CLEAR PC 400MM x 200MM	•	•	•	•	•	•
222157CL	VISOR CLEAR PC 400MM x 250MM	•	•	•	•	•	•
223181CL	VISOR CLEAR PC 300MM x 200MM	•	•	•	•	•	•
225901CL	VISOR CLEAR PC WITH CHINGUARD 400MM x 180MM	•	•	•	•	•	•
227947GN5	VISOR GREEN SHADE 5 PC 400MM x 240MM	•	•	•	•	•	•

NO VISOR HOLDER REQUIRED, ATTACHES TO HATS AND CAPS, HELMET MOUNTED HEARING PROTECTION CAN BE WORN							
VISORS							
227891	VISOR STATIONERY CLEAR PC 305W x 175 4 CLIP ATT CAP	•	•	•	•	•	•



226000WH Cap V-Gard White
764701 Visor Carrier
764703 Visor Sordin PC 20cm
SOR3602 Pro FM Helmet Mounted



763930 Earmuff MSA Sordin Exc HB
764745 Visor Carrier HB
764746 Visor Sordin Metal Mesh

Part No.	Description
229710WH6V	V-Gard Advance 500 Cap White 6PT Vented Sewn Sweatband
764701	Visor Carrier
764746	Visor Sordin Metal Mesh
766239	Sordin L/R Med Cap Muff 30mm

Part No.	Description
229710YE6V	V-Gard Advance 500 Cap Yellow 6PT Vented Sewn Sweatband
763142	Visor Holder
762116	Visor Mesh Fibreglass
763932	Earmuff, MSA Sordin Exc Helmet Mounted 30mm



764745 Visor Carrier HB BasicLine, ProLine, WW, CC, EXC, HPE

Visor Compatibility Chart

For use with non-MSA brand Safety Hard Hats and Caps

FACE, HEARING AND HEAD PROTECTION COMBINATIONS		left/RIGHT			SORDIN		WHERE EARMUFF IS NOT REQUIRED 25MM
		LOW WHITE HELMET MOUNTED 25MM	MEDIUM BLUE HELMET MOUNTED 25MM	HIGH YELLOW HELMET MOUNTED 25MM	EXC HELMET MOUNTED 25MM	HPE HELMET MOUNTED 25MM	
764701	VISOR CARRIER, MSA SORDIN						
VISORS	CERTIFIED TO EN 166, EN 1731						
764703	VISOR MSA SORDIN CLEAR PC 20CM (1, F, 3, 9)	•	•	•	•	•	•
765698	VISOR MSA SORDIN CLEAR PC 20CM FOR ELECTRICAL ARCS (B, 3, 8, 9)	•	•	•	•	•	•
764746	VISOR MSA SORDIN METAL MESH (S)	•	•	•	•	•	•
PC = Polycarbonate	Protection against:						
1 = Optical Class 1	3 = Liquid Splash						
Mechanical Strength:	8 = Short Circuit Electric Arc						
B = 120 m/sec	9 = Molten Metals and Hot Solids						
S = 12m/sec							
F = 45m/sec							
763142 VISOR HOLDER							
VISORS	CERTIFIED TO AS/NZS 1337 - HIGH IMPACT						
227947CL	VISOR CLEAR PC 400MM x 240MM	•	•	•	•	•	•
VISORS							
222154CL	VISOR TEMPGARD MEDIUM 400MM x 200MM CLEAR	•	•	•	•	•	•
225170CL	VISOR TEMPGARD CLEAR WITH CHINGUARD 400MM x 180MM	•	•	•	•	•	•
762115	VISOR MESH ALUMINIUM 390MM x 165MM	•	•	•	•	•	•
762116	VISOR MESH FIBREGLASS 390MM x 165MM	•	•	•	•	•	•
221411CL	VISOR CLEAR PC 400MM x 200MM	•	•	•	•	•	•
222157CL	VISOR CLEAR PC 400MM x 250MM	•	•	•	•	•	•
223181CL	VISOR CLEAR PC 300MM x 200MM	•	•	•	•	•	•
225901CL	VISOR CLEAR PC WITH CHINGUARD 400MM x 180MM	•	•	•	•	•	•
227947GN5	VISOR GREEN SHADE 5 PC 400MM x 240MM	•	•	•	•	•	•

left/RIGHT and Sordin Hearing Protection products with 25mm attachments are not certified to AS/NZS 1270. These 25mm Hearing Protection products are specifically designed for use with non-MSA safety hard hats and caps, they can not be used for MSA Safety Hard Hats and Caps. When using a specified visor and helmet mounted 25mm hearing protection product, the visor holder and/or carrier may not contour to the non-MSA safety hard hats and caps due to the design. MSA Visor Holders and/or Carriers are specifically designed for MSA Hard Hats and Caps which contour to the brims.

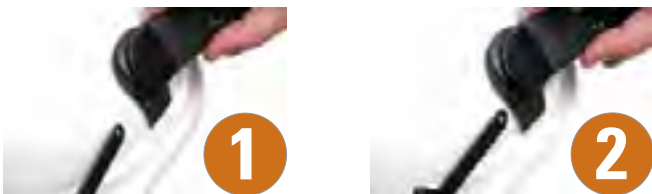

229710WH6V V-Gard Advance 500
6PT Vented Sewn Sweatband
766242 Sordin L/R Low Cap Muff 30mm
764701 Visor Carrier
764746 Visor Sordin Metal Mesh



229710WH6V V-Gard Advance 500
6PT Vented Sewn Sweatband
766244 Sordin L/R High Cap Muff 30mm
763142 Visor Holder
762116 Visor Mesh Fibreglass

Head Protection

V-Gard Protective Caps

MSA hardhats are made of ABS plastic, for a combination of lightweight and superior strength.

The exclusive “wear and fit” staz-on suspension allows for quick and simple personal size adjustment while wearing the cap.

The range of hard hats includes the V-Gard, V-Gard Advance **500** and V-CoolGard **200**.

The V-Gard and V-Gard Advance **500** are now certified under AS/NZS1801 to be worn in reverse (peak at rear), providing the retention system is fitted in reverse within the cap (therefore the retention system is worn in the regular orientation).



V-Gard Cap



The V-Gard has been awarded an Australian Design Mark in recognition of Industrial Protective Headwear. An extended peak provides greater visibility and extra protection from sun and rain.

The peak underside of V-Gard is lined with MSA's patented Glaregard textured surface, a feature that significantly reduces glare, helping to reduce eye strain caused by reflected light.

- Earmuff and visor attachment slots
- Rain protection gutter



V-Gard Advance 500 Cap



The V-Gard Advance **500** has genuine integrated 6 point suspension system. Lightweight design provides comfort over long periods.

This style offers better ear muff fit and rain protection. Glaregard textured surface under the peak reduces eye strain from glare. Venting in the top of the cap promotes air flow and gives a cooling effect for the wearer

- Earmuff and visor attachment slots
- Rain protection gutter



Colour	V-Gard Cap 4 Point Suspension	V-Gard Advance 500 Cap Vented 6 Point Suspension
White	226000WH	229710WH6V
Yellow	226000YE	229710YE6V
Green	226000GN	229710GN6V
Orange	226000OR	229710OR6V
Red	226000RE	229710RE6V
Blue	226000BU	229710BU6V
Fluoro Lime	226000FL	-

V-Gard Protective Caps and Hats

V-CoolGard 200 Cap



The style and comfort of the V-CoolGard **200** is achieved with a fully integrated 6 point suspension system.

Cool by name, cool by nature. When we say this is one of the coolest hard hats available we mean it. The venting in the cap provides superior air flow for improved wearer comfort over longer periods.

Available in a wide range of colours.

And remember all MSA hard hats can be customized with your company logo.

- Superior airflow for the coolest protection
- Earmuff and visor attachment slots
- Textured Glaregard Finish under Peak



Colour	V-CoolGard 200 Cap Vented 6 Point Suspension
White	229720WH6V
Yellow	229720YE6V
Green	229720GN6V
Orange	229720OR6V
Red	229720RE6V
Blue	229720BU6V

V-Gard Hat

- Hats feature a full circumference brim for greater protection
- Made from polypropylene

Colour	V-Gard Hat
White	220944WH
Yellow	220944YE
Green	220944GN
Orange	220944OR
Red	220944RE

V-Gard Advance 500 Chrome Look Cap



- Chrome look non vented cap
- Vaporised aluminium layer over cap inside & out to reflect radiant heat
- Clear polyester coating
- Reflects radiant heat keeping workers cooler in high temperature areas
- Note: Not AS/NZS 1801 approved

Part No.	Description
229710CHR6	V-Gard Advance 500 Chrome Look Cap



Head Protection

V-Gard Protective Caps

Hi Temperature Cap & Hat



Hi Temperature Caps & Hats

- Hi Temp Caps and Hats are made from polycarbonate
- V-Gard Hats feature full brim

Part No.	Description
762458WH4	V-Gard Advance 500 Cap White
762458YE4	V-Gard Advance 500 Cap Yellow
762458OR4	V-Gard Advance 500 Cap Orange
762458RE4	V-Gard Advance 500 Cap Red
222699WH	V-Gard Hat White
222698YE	V-Gard Hat Yellow



Miners Caps & Hats

- Caps and hats fitted with cap lamp bracket & cable clip
- Hats feature full brim
- Standard available stocks are fitted with metal lamp brackets. High quality plastic brackets are available as a make to order.

V-Gard Caps & Hats

Part No.	Description
226002WH	White metal lamp bracket
226002YE	Yellow metal lamp bracket
764443WH4	White plastic lamp bracket
764443YE4	Yellow plastic lamp bracket
224158WH	White full brim hat metal lamp bracket
224158YE	Yellow full brim hat metal bracket



V-Gard Advance 500 Cap

Part No.	Description
229351WH6V	White 6 point vented metal bracket
229351YE6V	Yellow 6 point vented metal bracket
764442WH6V	White 6 point vented plastic bracket
764442YE6V	Yellow 6 point vented plastic bracket

V-CoolGard 200 Cap

Part No.	Description
229350WH6V	White 6 point vented metal bracket
229350YE6V	Yellow 6 point vented metal bracket
764441WH6V	White 6 point vented plastic bracket
764441YE6V	Yellow 6 point vented plastic bracket



Generic Branded Caps

- Generic branded caps available in 4 styles

Part No.	Description
227501YE00651000	"Visitor" in Yellow
227501YE00381000	"Fire Warden" in Yellow
227501GN01291000	"First Aid" in Green
227501RE0265100	"Warden" in Red





Custom Branded Caps

- Apply your company logo and message to safety caps and hats for increased brand exposure
- Brand can be applied to front, rear and sides of caps and hats
- Rear logo stickers available for V-Gard Advance **500** caps & V-CoolGard **200**

CONTACT YOUR MSA REPRESENTATIVE OR PHONE CUSTOMER SERVICE FOR MORE INFORMATION

Reflective Sticker Banding

- Available in standard formats using plain or cross hatch tape
- Style A - V-Gard Advance **500** only
- Style B - V- CoolGard **200** only
- Styles C-H - V-Gard, V-Gard Advance **500**, V-CoolGard **200**

CONTACT YOUR MSA REPRESENTATIVE OR PHONE CUSTOMER SERVICE FOR MORE INFORMATION

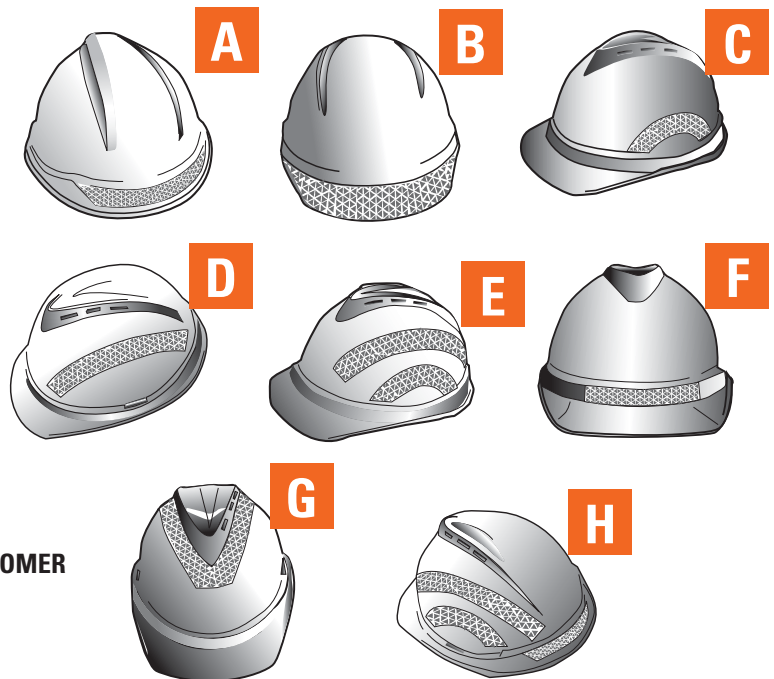

MSA Bumpgard

- Baseball cap with moulded inner shell & foam crown pad
- Protects from superficial injuries caused by bumping head against stationary objects
- Velcro adjustment strap provides individual fit

Part No.	Description
763254BU	Bumpgard Baseball Cap
763254BUF	With attached Neck Flap

- **Note - Not AS/NZS 1801 approved**

MSA Bumpcap

- Lightweight head protector
- Widely used in food preparation industry
- Side vents keep wearer cool

Part No.	Description
220819W	White

- **Note - Not AS/NZS 1801 approved**



Head Protection

Accessories for V-Gard Caps and Hats

Cap Visors

TEMPGARD - Suitable for higher temperature application

Description	Size	Part No.
Clear	400 x 200mm	222154CL
Clear with chinguard	400 x 180mm	225170CL

MESH - Low velocity particles plus more airflow

Description	Size	Part No.
Aluminium	390 x 165mm	762115
Fibreglass	390 x 165mm	762116

POLYCARB - Ideal general use, impact, heat and splash protection

Description	Size	Part No.
Clear	400 x 200mm	221411CL
Clear	400 x 250mm	222157CL
Clear	300 x 200mm	223181CL
Clear with chinguard	400 x 180mm	225901CL
Clear high impact	400 x 240mm	227947CL
Shade 5 high impact	400 x 240mm	227947GN5



Metal Mesh Visor



Sordin Visor



Metal Mesh Visor

Visors

The MSA SORDIN visor range is designed for those working environments where face protection is necessary. All visors are compatible with the passive hearing protectors; EXC and HPE, and the electronic hearing protectors: Basicline, Proline, Wireless World and Connected by Cable.

EN 166, EN 1731
(cartons of 20pcs)

Part No.	Description
764703	Clear PC visor, 20 cm (1, F, 3, 9)
765698	Clear PC visor, 20 cm, for electric arcs (B, 3, 8, 9)
764746	Metal mesh visor (S)

PC = Polycarbonate
1 = Optical class 1
Mechanical strength:
B = 120 m/sec
S = 12 m/sec
F = 45 m/sec

Protection against:
3 = liquid splash
8 = short circuit electric arc
9 = molten metals and hot solids



PC Visor



Nylon Mesh Visor

Visor Carriers

Carriers to connect visors to ear muffs or helmets.

EN 166, EN 1731
(cartons of 20pcs/pairs)

Part No.	Description
764701	Visor carrier for helmet mounting
764745	Visor carrier for headband Basicline, Proline, WW, CC, EXC & HPE
765274	Helmet Visor Adaptor where earmuffs are not used



Visor Carrier for Helmet Mounting



Visor Carrier for Headband

Accessories



Wide Sun Brim & Neck Flap

COOL COTTON BRIM WITH ATTACHED NECKFLAP FOR MAXIMUM SUN PROTECTION

V-Gard Advance 500 & V-CoolGard 200

Part No.	Description
762546WH	White
762546BU	Blue
762546OR	Orange

V-Gard

Part No.	Description
225689WH	White
225689BU	Blue



Chin Strap Elastic

ASSORTED ACCESSORIES

Part No.	Description
222150	General purpose cap attachment earmuffs
222151	Visor Holder - fits into earmuff attachment (Refer page 61 for visors)
222158	Visor Adapter - where earmuff not used
220553	Chin Strap Elastic
224047	Sweatband Terry Towelling (velcro fit)
765550	Sweatband, Terry Towelling, Lug Style
225690	Sweatband Sheepskin (velcro fit)
224405	Neck Flap Woollen
229068	Neck Flap Proban Yellow

Cap Attachment Earmuffs



Sordin EXC



Sordin HPE



MSA SORDIN

Part No.	Description
763932	Sordin EXC Cap Attachment earmuff Class 5
763934	Sordin HPE Cap Attachment High Performance earmuff Class 5
763142	Visor Holder (Sordin & HiLo) - (Refer page 61 for visors)
765274	Helmet Visor Adaptor where earmuffs are not used



Head Protection

Bushfire Helmets

- Australian made for Australian conditions
- Approved to AS/NZS1801: Type III
- Hi-Temp shells
- High strength or specified break chinstrap options

Part No.	Description
764467WH	Advance Cap Style 4.10 High strength retaining Chinstrap
764468WH	Advance Cap Style 4.11 Specified breakpoint Chinstrap
764465WH	V Gard Hat 4.10 High strength retaining Chinstrap
229068	Neck Flap Refer Page 61 for visors (Advance Style Only)



Structural Helmets

- High temperature foam liner with patented breakaway system
- Nomex ear/neckflap - Nomex quick release chinstrap
- Standard 4" or optional 6" visor
- Available in white, red, lime yellow, orange

CONTACT YOUR MSA REPRESENTATIVE FOR MORE INFORMATION

Part No.	Description
762962LY	Cairns 660CAS Metro Helmet Lime Yellow
762962WH	Cairns 660CAS Metro Helmet White

3-Position Rear Ratchet Height Adjustment
Ensures a secure and comfortable fit for all head sizes (52cm - 64cm)

Adjustable Front Headband
Allows perfect fit between helmet and SCBA mask without lifting helmet or exposing forehead

Patented Shock-Absorbing Tube
Maximises impact protection

Non-corroding, high-temperature-resistant faceshield hardware.

Rugged, high-temperature edge will not melt or drip

Durable helmet hanger fits on large hooks and resists bending

Minimal parts for lower service cost and easier maintenance

Approved to AS/NZS4067

Spare Parts

Part No.	Description
L655XP	Neck Flap
LK28P	Cushion Liner
RHBP	Ratchet Headband
10037315	4" Visor
S806CP	6" Visor
763910	Spares Kit (Washers, Screws, Circlips)

F2 Xtrem

MSA's F2 Xtrem Helmet responds to all extreme applications. The Quick Click head size adjustment reinforces the ease and functionality of the helmet, without compromising comfort.

The F2 Xtrem is made from engineered hi-temp polycarb, which provides greater balance and a lower centre of gravity.

The F2 Xtrem is lightweight for more comfort and is effective in action, responding to customer needs under the most extreme and dangerous conditions when exposed to fire.

Features and Benefits

- 3 position sizing headband that creates better comfort and balance.
- Leather sweatband provides better breathability, absorbs perspiration.
- Additional adjustable suspension netting provides better comfort, breathability and balance.
- 6 chinstrap adjustments, positioned ergonomically for greater balance and comfort.
- Quick Click head size adjustment that is glove friendly.



Part No.	Description
765938FO	Gallet F2 Xtrem Helmet FLURO ORANGE
765938PE	Gallet F2 Xtrem Helmet PHOTOLUMINESCENT
765938RE	Gallet F2 Xtrem Helmet RED
765938WH	Gallet F2 Xtrem Helmet WHITE
765938YE	Gallet F2 Xtrem Helmet YELLOW

The F2 Xtrem Helmet fully complies with and is certified to AS/NZS1801 Type III (Bushfire Helmet)

Accessories

Part No.	Description
766347	Aluminised Neckflap
766079	Wool Neckcurtain



Head Protection

Firefighter Helmets

Real Protection Systems

It is essential for firefighters to protect themselves while performing their difficult and dangerous work. The universal, modular, high technology head protection system F1 has been designed in cooperation with fire brigades around the world. Its unique design protects the firefighter against penetration, fire electric shock and radiant heat.



F1 SF Helmet



F1 E Helmet

The helmet system offers a wide variety of options such as a comprehensive range of neck curtains and visors, as well as adaptable face masks, lamps and communication systems. The mask-helmet-combination offers even greater breathing protection. The special face mask can be attached directly without necessitating the removal of the helmet.

F1 SF Helmet MSA GALLET

Based on the original F1 helmet, the F1 SF is especially designed for Structural Firefighting [SF] for firefighters worldwide. The F1 SF features built-in interfaces on both sides to become a flexible head protection platform for different types of accessories. Its mask adapter KitFix can be easily adjusted for perfect mask attachment and optimal wearing comfort. What's more, the F1 SF is designed with a ratchet cradle [quick adjustment on the head] and a new 3-point fireproof, adjustable chinstrap providing increased comfort and stability.

The F1 SF is available in a variety of helmet and front plate colours.

EN 443 : 2008 (Complete with Neckflap)

Part No.	Description
GA230X	F1 SF painted standard helmets
GA235X	F1 SF painted ratchet helmets
GA240X	F1 SF nickel standard helmets
GA245X	F1 SF nickel ratchet helmets
GA1109	Aluminized neck curtain
GA1110	Integral neck curtain, fireproof

X = according to face-shield [9% gold, 43% gold or transparent]



F1 E Helmet MSA GALLET

The F1 E is a very high performance helmet for structural fire-fighting aimed for large head size firemen, for sizes from 58 to 64 cm. The comfortable headgear is provided with either standard adjustment or quick ratchet adjustment. The spherically shaped face shield protects against heat and glare, with 3 options: gold, transparent and semi-tinted. The F1E helmet features a KitFix system with 3-position adjustment to optimize SCBA mask tension and wearer comfort. Furthermore it is designed with a 3-point chinstrap with automatic buckle for optimum stability.

The F1 E is available in a variety of helmet and front plate colours.

EN 443 : 2008 (Complete with Neckflap)

Part No.	Description
GA170X	F1 E painted standard helmets
GA175X	F1 E painted ratchet helmets
GA185X	F1 E nickel ratchet helmets

X = according to face-shield [9% gold, 43% gold or transparent] and chinstrap [2-point buckle or 3-point buckle]



Firefighter Helmets



FUEGO Helmet

FUEGO Helmet MSA GALLET

FUEGO is the perfect head protection solution for Fire & Rescue and Emergency Services who demand high performance as well as cost effectiveness without compromise. FUEGO is provided with a quick adjustment headband with Velcro fastening and height adjustment [2 on the front, 3 on the rear]. It is designed with built-in interfaces for accessories [lamp, external face shield] including adjustment capability [lamp angular position]. Moreover, this helmet includes a 4-point chinstrap, with 4 adjustments [2 on the front, 2 on the rear] for optimal stability.

EN 443 : 2008 (Complete with Neckflap)

Part No.	Description
GA290X	FUEGO helmets

X = according to helmet colour and included accessories



Head Protection

Police Helmets

High Performance Law Enforcement Helmet

Police and law enforcement forces are subject to a wide variety of threats and physical attacks during the course of their work. Therefore they need personal protective equipment which they can rely on at all times. MSA GALLET offers a range of law enforcement helmets with a high

quality of performance, intended for riot control during demonstrations or other incidents of public disorder, where the wearer is exposed to risk of injury from projectiles, gas, smoke and other hazards. The helmets and full face masks together create a total head and respiratory protection system.



MO 5006 with 3S-H-A Mask

MO 5006 Helmet MSA GALLET

The jet-shaped helmet shell is equipped with a comfortable, soft inner padding, 3 point chinstrap with locking buckle and anti-strangulation system, a curved faceshield and a 4-stud neck curtain. The integration of a bone microphone communication system is possible. The helmet is resistant to damage and penetration from blunt and sharp objects, and protects against chemical aggression, as well as fire and flames.

With the face mask 3S-H-A, the MO 5006 can be enhanced with an integrated mask-helmet protection system that meets international requirements. The helmet is available for head sizes from 51 to 64 cm in white, black and olive-green.

Accessories: protection cover, carrying bag, belt buckle.

EN136

Part No.	Description
GA5006*X	MO 5006 with curved face-shield and 4-stud neckcurtain
GA5016*X	MO 5006 with curved face-shield, add-on anti-fog Pinlock® & 4-stud neckcurtain

* Helmet colour references: White = BE, Olive-green = VK, Black = NE, Green = VA, Matt Black = BU [only for GA5006*X] X: Depending on the size [available from XXXS to XXXL]



3S-H-A Police

3S-H-A Police Full Face Mask

EN136

Part No.	Description
10058157	3S-H-A Police, with carrying strap
10061667	3S-H-A Police, small, with carrying strap
10058272	3S-H-A Police, without carrying strap
10061666	3S-H-A Police, small, without carrying strap



MO 5001R with bulb face-shield

MO 5001R and MO5011R Helmet MSA GALLET

The MO 5001R / MO 5011R is intended for riot control and law enforcement operations with risks of projectiles, gas, smoke, etc. It is compatible with the adaptation of a respiratory mask and can be either hold with a bulb anti-shock face-shield [MO 5001R] or with a curved one [MO 5011R].

Part No.	Description
GA5001R*	MO 5001R with anti-shock bulb face-shield [2 mm]
GA5011R*	MO 5011R with anti-shock curved face-shield [4 mm] Leaflet 37-108.2

* Helmet colour references: White= BA, Blue= IA, Black= NE



MO 5011R with curved face-shield

3S-H-5001 Police Full Face Mask

Part No.	Description
10044208	3S-H-5001
10045465	3S-H-5001, small

Accessories for Firefighter and Police Helmets

Communication Systems OSTEО

OSTEO uses the principle of osseous sound transmission, whereby background noises are effectively filtered out. This system is available for more than 100 different types of radios. Disconnecting the plug will automatically switch the system back to radio PTT. Great transmitting power and high sound quality.

Part No.	Description
0102X11XX	OSTEO System with plug for F1 helmets
0102X12XX	OSTEO System with plug for F2 helmets



MICRO

The MICRO system is a microphone and a loud-speaker in one. Small and light, the MICRO can be easily fitted into the helmet, or it can be used independently, for example, in gas tight suits. This system is available for more than 100 different types of radios.

Part No.	Description
0103X11XX	MICRO System with plug for F1 helmets
0103X12XX	MICRO System with plug for F2 helmets



L'COM

L'COM is a non-integrated, independent communication kit that is worn separately inside the helmet. The ears remain free allowing wearers to remain in immediate contact with their surroundings. Its revolutionary technology makes it one of the most advanced communication systems of its kind. A high level of safety is provided by the self-breaking plug and automatic switch-over to radio PTT.

Part No.	Description
0104X11XX	L'COM System with plug



Lamps



Lamp XP

Approved according to ATEX standard Zone1 and T5 approved for use with PPE equipment, the lamp XP is extremely powerful and can be attached to helmets using a choice of flashlight adapters. Its xenon laser spot module allows better penetration through water, smoke, fog and rain. Moreover, the self-luminescent light cap can be easily seen in the dark.

Part No. 763043



Lamp XP LED

The new lamp XP LED - Light Emitting Diode - not only uses the advantages of LED technology but also provides a long beam [RECOIL]. It is designed for a 32 h burning time with 4 batteries. It provides 32 lumens with a 1 watt LED.

Part No. 766077

Other Accessories



Neck Curtains

Various neck curtains for F1, F2 X-TREM and FUEGO helmets.



Ear Muffs for MSA GALLEТ Helmets

Ear muffs mounted on helmet especially designed for the F2 X-TREM helmets.